

Coaxial Cable Stripper



Three internal circular steel blades perform precise, extremely clean and easy stripping.

Model	Preset to
TS100E	LV-77S-L-5CFB, V*-5CFB, V*-5C, LV-61S-L-4CFB, V*-3C
TS100U <small>NEW</small>	L-2.5CHD, 1855A, 1505A, 1694A

- For most Canare BNC, DIN, RCA and F crimp plugs.
- Rotary knob to select 5 different cable setups.
- Make your own cable setting within cable O.D. 4mm~11mm
- Hex wrench is attached on the lid top for quick adjustment.
- One replacement blade included, and also sold separately.
Replacement blade: TSC (1pc)

Note:

The following types of cables may not be accurately processed by Canare's TS100 Cable Stripper, owing to their construction.

1. Cables employing such hard jacket material as polyethylene.
2. Cables employing such particularly soft insulator material as high-foam polyethylene.
3. Cables employing steel wire and semirigid pipe for outer conductor.



TS100E

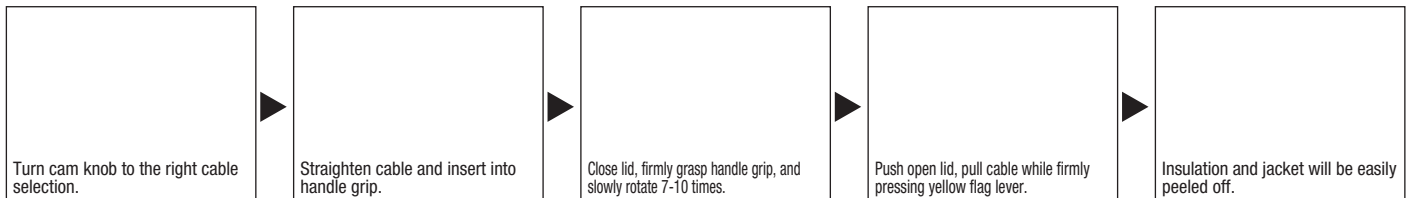
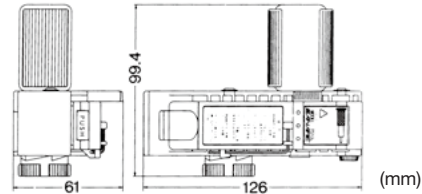

Crimp Tools

Canare crimp tool offers reliable high-quality crimping performance in an easy-to-use design.

Die Sets

Hand Crimp Tools

Model	Model
TCD-1DB	TC-1
TCD-31C	
TCD-3151D	
TCD-316C	
TCD-35CA	
TCD-35D	
TCD-35DF	
TCD-4CA	
TCD-451CA	
TCD-55FA	
TCD-5CF	
TCD-5HD	
TCD-65C	
TCD-67HD	
TCD-7CA	
TCD-96C	TC-2
TCD-D253F	TC-1
TCD-D534F	

Accessories

Model	Description	Length
TB-2A	Tool case	—
BET-12	Extraction tool for BNC straight plug	12 inch
BET-MBNC	Extraction tool for MBCP-C series	30 cm
BET-DIN	Insertion / extraction tool for DCP-C series	30 cm

- Select the appropriate die set to suit the individual connector
- Hand crimp tool is required for die set, and sold separately
- Die set are interchangeable

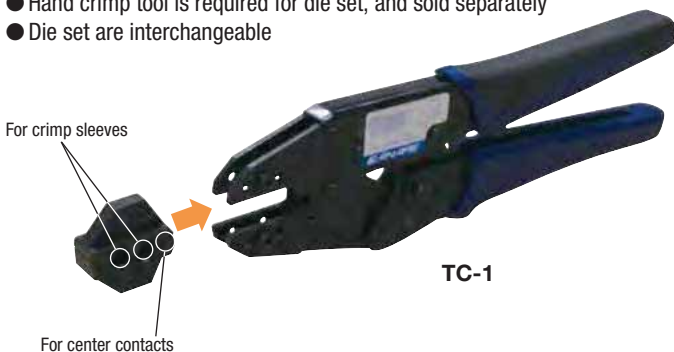

TC-1



TB-2A
(tools and connectors not included)



BET-12

BET-MBNC

BET-DIN